

Expansion Area 6

Expansion Area 6 includes the following zoning district classifications: M-1 (Light Industrial District) and M-2 (Heavy Industrial District).

See EXHIBIT 2: Official Zoning for the Expansion Areas which graphically shows the location of the each zoning district on individual maps of the Expansion Areas.

EXHIBIT 2 – Official Zoning for the Expansion Areas

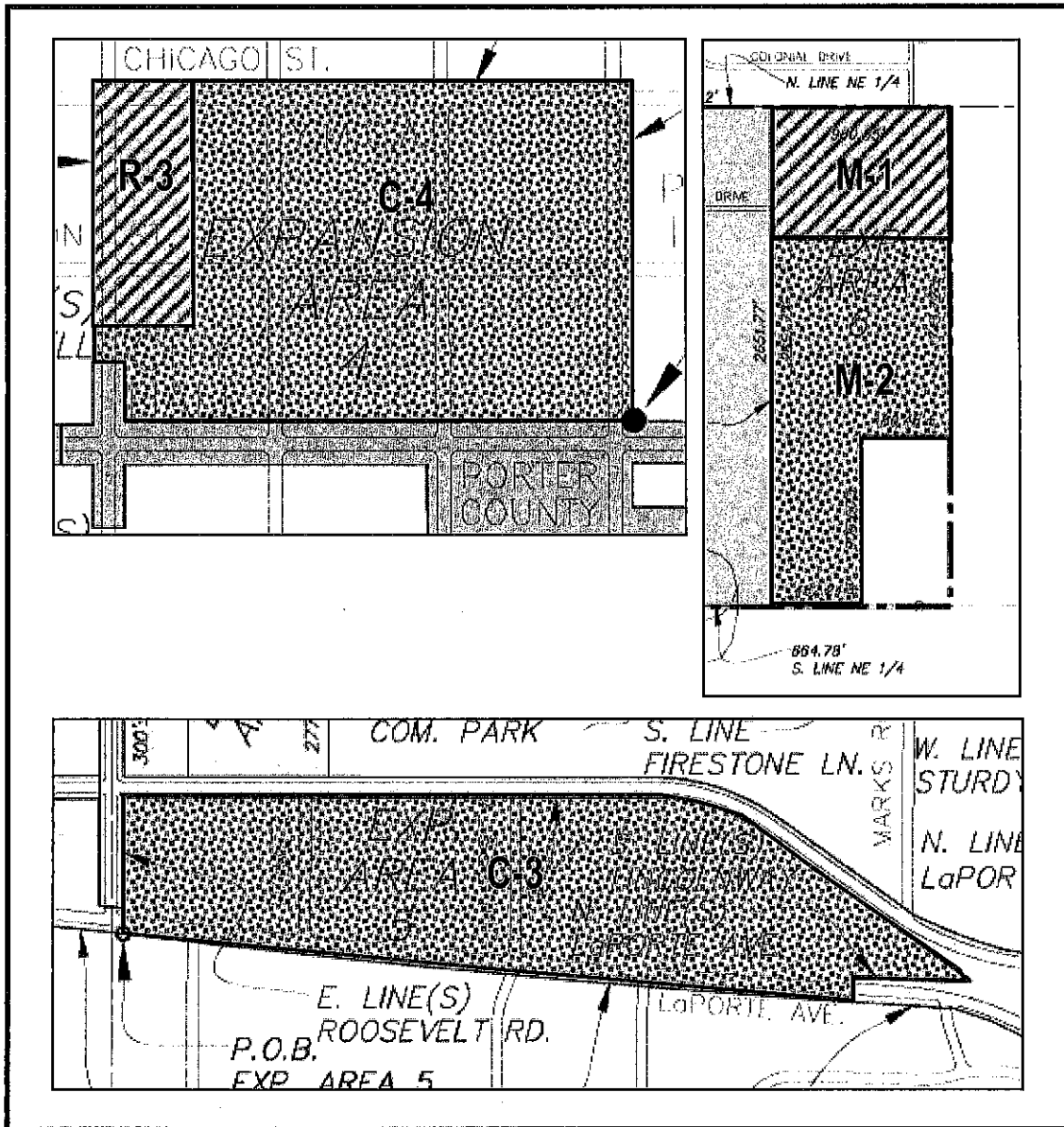
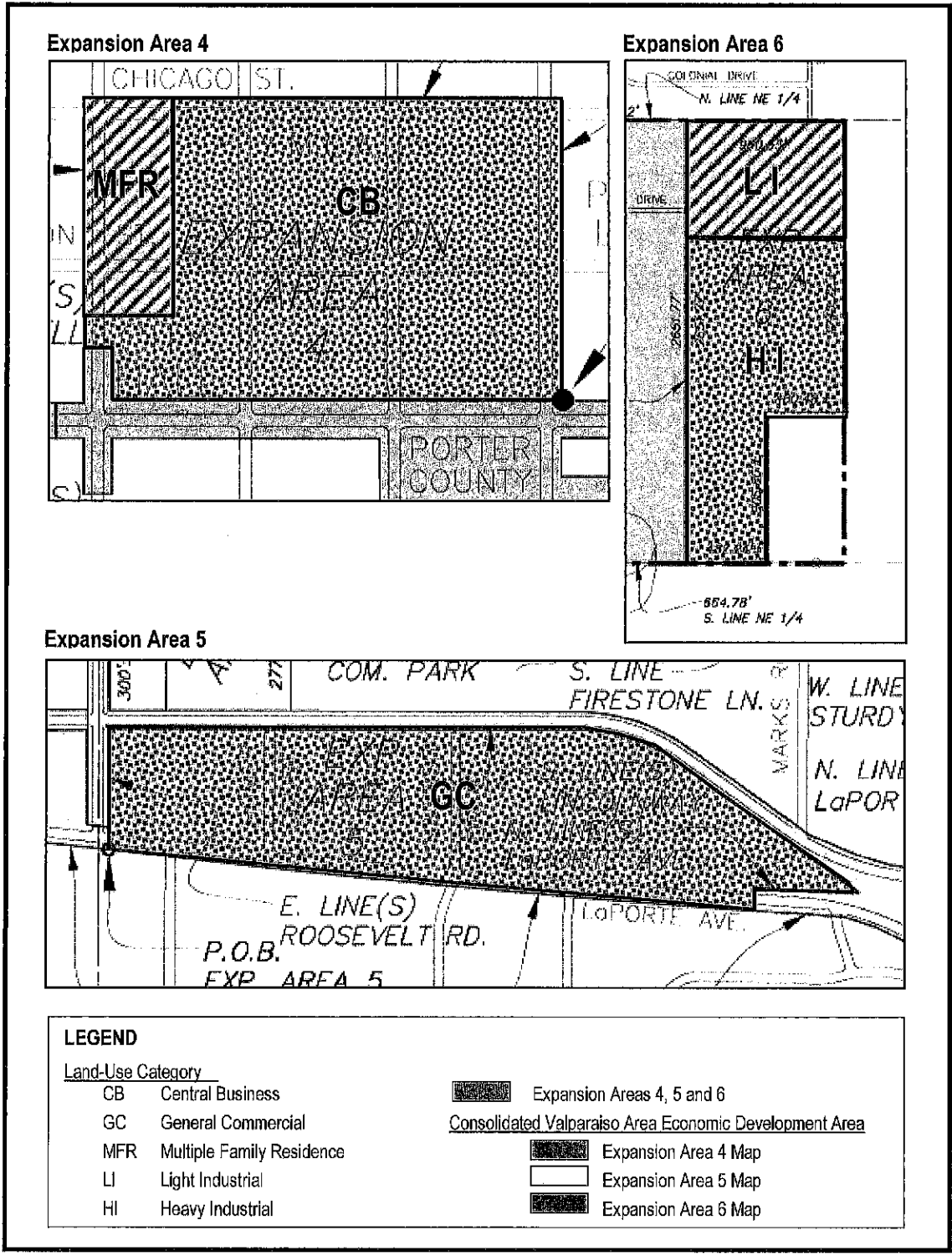

EXHIBIT 3 – Land-Use Plan for the Expansion Areas



EXPANSION AREA 4

Boundary Description

An irregularly shaped parcel of land tangential to the Consolidated Valparaiso Economic Development Area located in the Southwest Quarter of Section 24 in Township 35 North, Range 6 West of the Second Principal Meridian all in Center Township, Porter County, Indiana, said expansion area located in the City of Valparaiso, Indiana and as shown within the plat of the Original Survey to said City per Deed Record D-A-13 of Valparaiso and the plat of the Outlots to said Original Survey per Deed Record D-A-621, more particularly described as follows:

BEGINNING AT THE INTERSECTION THE NORTH RIGHT-OF-WAY LINE OF LINCOLNWAY (ALSO KNOWN AS STATE ROAD 130) AND THE WEST RIGHT-OF-WAY LINE OF NAPOLEON STREET, ALSO BEING THE SOUTHEAST CORNER OF LOT 8 IN BLOCK 39; THENCE NORTH ALONG SAID WEST RIGHT-OF-WAY LINE OF NAPOLEON STREET TO THE NORTHEAST CORNER OF SAID LOT 8, BEING THE POINT OF BEGINNING WITH SAID POINT AND SUBSEQUENT COURSES BEING TANGENTIAL TO THE CONSOLIDATED VALPARAISO ECONOMIC DEVELOPMENT AREA; THENCE EAST ACROSS SAID NAPOLEON STREET TO THE EAST RIGHT-OF-WAY LINE OF SAID NAPOLEON STREET AND THE NORTHWEST CORNER OF LOT 5 IN BLOCK 16 OF SAID ORIGINAL SURVEY; THENCE SOUTH ALONG SAID EAST RIGHT-OF-WAY LINE OF NAPOLEON STREET TO SAID NORTH RIGHT-OF-WAY LINE OF LINCOLNWAY (ALSO KNOWN AS STATE ROAD 130) AND THE SOUTHWEST CORNER OF SAID LOT 5; THENCE EAST ALONG SAID NORTH LINE OF LINCOLNWAY (ALSO KNOWN AS STATE ROAD 130) TO THE EAST RIGHT-OF-WAY LINE OF FRANKLIN STREET (COMPLETING SAID TANGENTIAL BOUNDARY WITH THE CONSOLIDATED VALPARAISO ECONOMIC DEVELOPMENT AREA); THENCE NORTH ALONG THE EAST RIGHT-OF-WAY LINE OF FRANKLIN STREET TO THE NORTH RIGHT-OF-WAY LINE OF CHICAGO STREET; THENCE WEST ALONG THE NORTH RIGHT-OF-WAY LINE OF CHICAGO STREET TO THE WEST RIGHT-OF-WAY LINE OF NAPOLEON STREET; THENCE SOUTH ALONG THE WEST RIGHT-OF-WAY LINE OF NAPOLEON STREET TO ITS INTERSECTION WITH ALONG SAID NORTHEAST CORNER OF SAID LOT 8 IN BLOCK 39, BEING THE POINT OF BEGINNING, CONSISTING OF 17.2 ACRES MORE OR LESS.

Expansion Area 4 Map

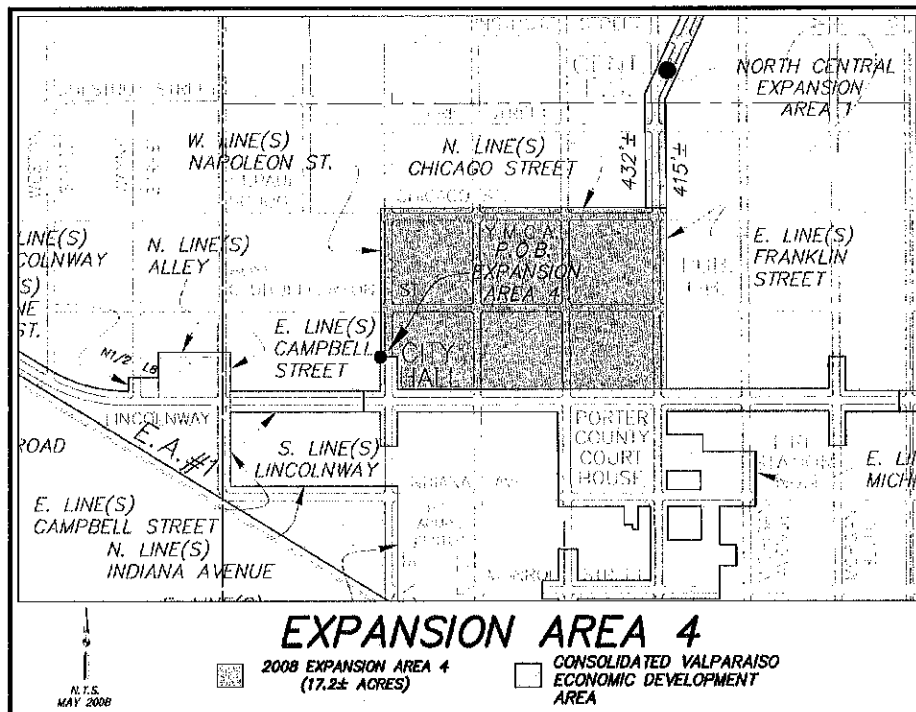

EXPANSION AREA 5

Boundary Description

An irregularly shaped parcel of land tangential to the Consolidated Valparaiso Economic Development Area located in the Southwest Quarter of Section 19 in Township 35 North, Range 5 West of the Second Principal Meridian all in Center Township, Porter County, Indiana, said expansion area located in the City of Valparaiso, Indiana, more particularly described as follows:

BEGINNING AT THE INTERSECTION OF THE SOUTH RIGHT-OF-WAY LINE OF LAPORTE AVENUE AND THE EAST RIGHT-OF-WAY LINE OF ROOSEVELT ROAD AS THE POINT OF BEGINNING, SAID POINT AND SUBSEQUENT COURSES BEING TANGENTIAL TO THE CONSOLIDATED VALPARAISO ECONOMIC DEVELOPMENT AREA; THENCE NORTH ALONG SAID EAST RIGHT-OF-WAY LINE OF ROOSEVELT ROAD TO THE SOUTH RIGHT-OF-WAY LINE OF LINCOLNWAY (ALSO KNOWN AS STATE ROAD 130); THENCE EASTERLY AND SOUTHEASTERLY ALONG SAID SOUTH RIGHT-OF-WAY LINE OF LINCOLNWAY (ALSO KNOWN AS STATE ROAD 130) TO THE NORTH RIGHT-OF-WAY LINE OF SAID LAPORTE AVENUE; THENCE WEST ALONG SAID NORTH LINE OF LAPORTE AVENUE APPROXIMATELY 300 FEET; THENCE SOUTH ACROSS SAID LAPORTE AVENUE TO THE SOUTH RIGHT-OF-WAY LINE OF LAPORTE AVENUE (COMPLETING SAID TANGENTIAL BOUNDARY WITH THE CONSOLIDATED VALPARAISO ECONOMIC DEVELOPMENT AREA); THENCE NORTHWEST ALONG SAID SOUTH RIGHT-OF-WAY LINE OF LAPORTE AVENUE TO THE EAST RIGHT-OF-WAY OF ROOSEVELT ROAD, BEING THE POINT OF BEGINNING, CONSISTING OF 17.8 ACRES MORE OR LESS.

Expansion Area 5 Map

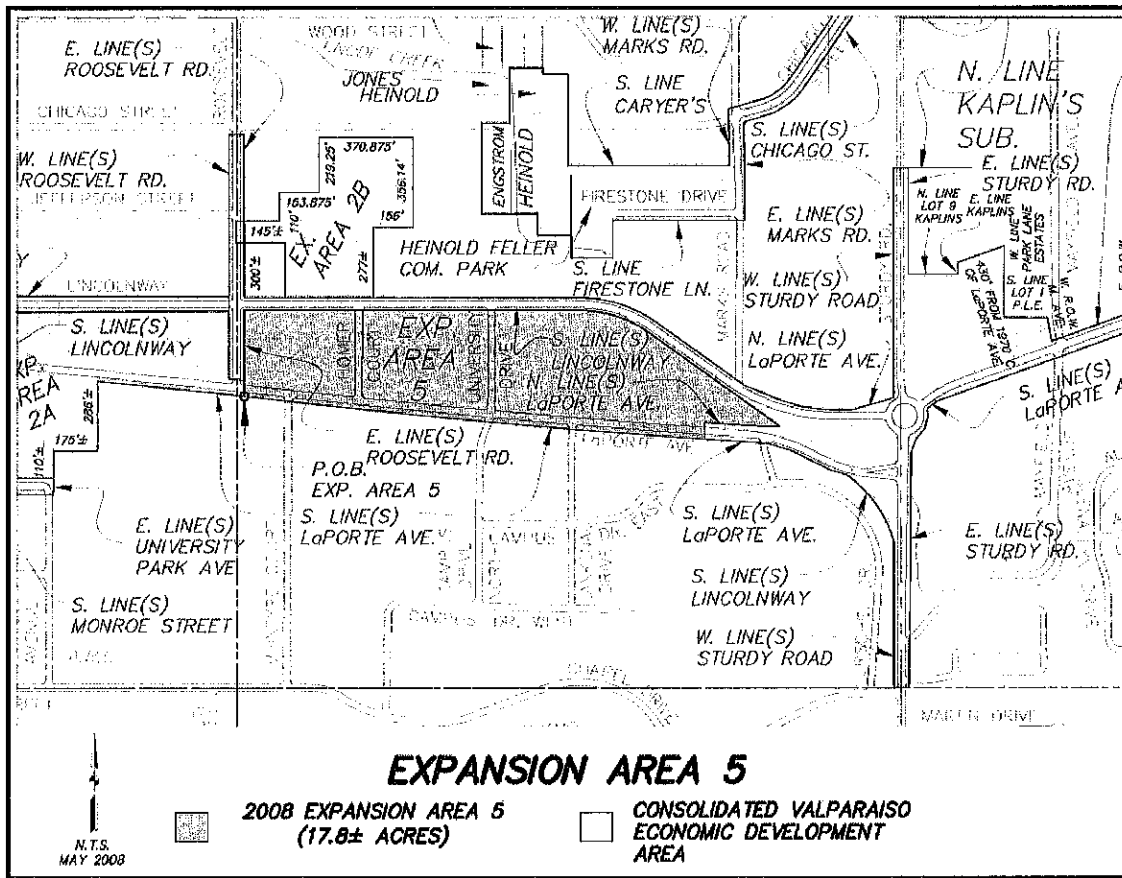

EXPANSION AREA 6

Boundary Description

An irregularly shaped parcel of land tangential to the Consolidated Valparaiso Economic Development Area located in the Northeast Quarter of Section 29 in Township 35 North, Range 5 West of the Second Principal Meridian all in Washington Township, Porter County, Indiana, said expansion area located in the City of Valparaiso, Indiana, more particularly described as follows:

BEGINNING AT THE CENTER OF SECTION 29, THENCE EAST ALONG THE SOUTH LINE OF THE NORTHEAST QUARTER APPROXIMATELY 664.78 FEET TO THE POINT OF BEGINNING, SAID POINT AND SUBSEQUENT COURSE BEING TANGENTIAL TO THE CONSOLIDATED VALPARAISO ECONOMIC DEVELOPMENT AREA; THENCE NORTH 2,651.77 FEET TO ITS INTERSECTION WITH THE NORTH LINE OF SAID SECTION 29, SAID LINE ALSO BEING THE VALPARAISO CITY LIMITS (COMPLETING SAID TANGENTIAL BOUNDARY WITH THE CONSOLIDATED VALPARAISO ECONOMIC DEVELOPMENT AREA); THENCE FOLLOWING THE SUBSEQUENT COURSES: EAST ALONG SAID NORTH LINE (ALSO BEING THE NORTH LINE OF THE NORTHEAST QUARTER) OF SAID SECTION 29 AND THE VALPARAISO CITY LIMITS APPROXIMATELY 960.55 FEET, SOUTH APPROXIMATELY 1,743.72 FEET ALONG SAID VALPARAISO CITY LIMITS, WEST APPROXIMATELY 480.48 FEET, AND SOUTH APPROXIMATELY 906.60 FEET TO ITS INTERSECTION WITH SOUTH LINE OF THE NORTHEAST QUARTER OF SAID SECTION 29, SAID POINT ALSO BEING THE VALPARAISO CITY LIMITS, THENCE WEST ALONG SAID SOUTH LINE OF THE NORTHEAST QUARTER OF SECTION 29 AND THE VALPARAISO CITY LIMITS APPROXIMATELY 482.24 FEET TO THE POINT OF BEGINNING, CONSISTING OF 48.00 ACRES MORE OR LESS.

Expansion Area 6 Map

