

# Appendix



# Appendix

## Table of Contents

- Accident Data and Pavement Analysis
- Transportation Facility Analysis
- Figure A.1, Water Main Concept Plan
- Figure A.2, Sanitary Sewer Concept Plan

## Accident Data and Pavement Analysis

Pavement surfaces were evaluated to determine the current condition using the PASER Manual for Asphalt Roads.

Principal Corridor	Corridor Description	Condition Assessment
SR 49	US 30 to US 6	Fair
LaPorte Avenue	W. of SR 49	Poor
LaPorte Avenue/SR 2	E. of SR 49	Fair/Poor
Evans Avenue	W. of SR 49	Poor
Evans Avenue	E. of SR 49	Poor
Vale Park Road/CR 400N	Silhavy Road to SR 49	Very Good
Vale Park Road/CR 400N	SR 49 to CR 325 E	Fair
Burlington Beach Road/ CR 500 N	W. of SR 49	Good
Burlington Beach Road/ CR 500 N	E. of SR 49	Good
CR 600 N	E. of SR 49	Very Good
Silhavy Road	S. of Vale Park Road	Fair
Silhavy Road	N. of Vale Park Road	Fair
Bartz Road	Evans Avenue to CR 400 N	Good
CR 325 E	Evans Avenue to CR 500 N	Fair

The following intersections, road segments and interchange ramps, located within the project corridor, were documented as having high crash rates and subsequently included in Indiana's Five Percent Report:

Report Year	Location	Fatal/ Incap. Injury Accident	Non- Incap. Injury Accident	PDO Accident	Total Accidents
2011	Intersection of Meridian Rd at W. CR 700 N	2	15	17	34
2011	Intersection of E. CR 600 N at N. CR 200 E	2	12	16	30

The following intersections, road segments are located within the project corridor:

Report Year	Location	Fatal/ Incap. Injury Accident	PDO Accident	Total Accidents
2010 - 2012	Intersection of LaPorte Avenue at SR49	28	87	115
2010 - 2012	Intersection of LaPorte Avenue at Sturdy Road	6	45	51
2010 - 2012	Intersection of LaPorte Avenue at Silhavy Road	11	25	36
2010 - 2012	Intersection of Evans Avenue at Calumet Road	7	24	31
2010 - 2012	Intersection of Mortland Drive at Strongbow Centre Drive	5	25	30
2010 - 2012	Intersection of Glendale Boulevard at Roosevelt Road	8	15	23
2010 - 2012	Intersection of Glendale Boulevard at Calumet Avenue	10	11	21
2010 - 2012	Intersection of LaPorte Avenue at Legend Drive	2	18	20
2010 - 2012	Intersection of Burlington Beach Road at Calumet Avenue	3	15	18
2010 - 2012	Intersection of Mortland Drive at Sturdy Road	6	12	18
2010 - 2012	Intersection of Vale Park Road at Calumet Avenue and Roosevelt Road	5	12	17
2010 - 2012	Intersection of Mortland Drive at Industrial Drive	2	14	16
2010 - 2012	Intersection of Mortland Drive at SR49	9	5	14
2010 - 2012	Intersection of Mortland Drive at SR49	6	7	13
2010 - 2012	Intersection of Evans Avenue at Roosevelt Road	3	8	11
2010 - 2012	Intersection of Vale Park Road at Silhavy Road	2	6	8
2010 - 2012	Intersection of Burlington Beach Road at Silhavy Road	2	6	8
2010 - 2012	Intersection of Bullseye Lake Road and Calumet Avenue	2	4	6
2010 - 2012	Intersection of Country Club Road at Silhavy Road	0	4	4
2010 - 2012	Intersection of LaPorte Avenue at Eastport Centre Drive	2	1	3
2010 - 2012	Intersection of Evans Avenue at Sturdy Road	1	2	3
2010 - 2012	Intersection of Glendale Boulevard at Silhavy Road	1	1	2

## Transportation Facility Analysis

The existing geometry at each of the study Intersections is as follows:

### State Road 49 & LaPorte Avenue/State Road 2 (signalized)

- LaPorte Avenue eastbound – 2 through lanes, 1 channelized right turn lane (yield)
- LaPorte Avenue westbound – 2 through lanes, 1 auxiliary lane
- SR 2 eastbound – 1 left turn lane, 2 through lanes
- SR 2 westbound – 2 through lanes, 1 channelized right turn lane (yield)
- SR 49 northbound off-ramp – 1 left turn lane, 1 channelized right turn lane (yield)
- SR 49 southbound off-ramp – 1 left turn lane, 1 channelized right turn lane (yield)

### State Road 49 & Vale Park Road/County Road 400 N (double-roundabout interchange)

- Vale Park Road/CR 400 N eastbound – 1 roundabout approach lane (yield)
- Vale Park Road/CR 400 N westbound – 1 roundabout approach lane (yield)
- SR 49 northbound off-ramp – 1 roundabout approach lane (yield)
- SR 49 southbound off-ramp – 1 roundabout approach lane, 1 channelized right turn lane (yield)

### State Road 49 & Burlington Beach Road/County Road 500 N (signalized)

- Burlington Beach Road eastbound – 1 shared left/through/right lane
- CR 500 N westbound – 1 shared left/through/right lane
- SR 49 northbound – 1 left turn lane, 2 through lanes, 1 right turn lane
- SR 49 southbound – 1 left turn lane, 2 through lanes, 1 right turn lane

### State Road 49 & County Road 600 N (unsignalized – 2-way stop)

- CR 600 N eastbound – 1 shared left/through/right lane
- CR 600 N westbound – 1 shared left/through/right lane

- SR 49 northbound – 1 left turn lane, 2 through lanes, 1 right turn lane
- SR 49 southbound – 1 left turn lane, 2 through lanes, 1 right turn lane

### Silhavy Road & LaPorte Avenue/State Road 2 (signalized)

- LaPorte Avenue eastbound – 1 left turn lane, 2 through lanes, 1 right turn lane
- LaPorte Avenue westbound – 1 left turn lane, 2 through lanes, 1 right turn lane
- Silhavy Road northbound – 1 left turn lane, 1 through lane, 1 shared through/right turn lane
- Silhavy Road southbound – 1 left turn lane, 1 through lane, 1 shared through/right turn lane

### Silhavy Road & Vale Park Road (roundabout)

- Vale Park Road eastbound – 1 roundabout approach lane (yield)
- Vale Park Road westbound – 1 roundabout approach lane (yield)
- Silhavy Road northbound – 1 roundabout approach lane (yield)
- Silhavy Road southbound – 1 roundabout approach lane (yield)

### Silhavy Road & Burlington Beach Road (unsignalized – 2-way stop)

- Burlington Beach Road eastbound – 1 shared left/through/right turn lane
- Burlington Beach Road westbound – 1 shared left/through/right turn lane
- Silhavy Road northbound – 1 shared left/through/right turn lane
- Silhavy Road southbound – 1 shared left/through/right turn lane

### LaPorte Avenue/State Road 2 & Porter's Vale Boulevard/Eastport Centre Drive (signalized)

- Eastport Centre Drive northbound – 1 left turn lane, 1 shared through/right turn lane
- Porter's Vale Boulevard southbound – 1 left turn lane, 1 through lane, 1 right turn lane

- SR 2 eastbound – 2 left turn lanes, 2 through lanes, 1 right turn lane
- SR 2 westbound – 1 left turn lane, 2 through lanes, 1 right turn lane

### Evans Avenue & Bartz Road (unsignalized – stop sign)

- Bartz Road southbound – 1 shared left/right turn lane
- Evans Avenue eastbound – 1 shared left/through lane
- Evans Avenue westbound – 1 shared through/right turn lane

### Vale Park Road/County Road 400 N & Bartz Road (unsignalized – 3-way stop)

- Bartz Road northbound – 1 shared left/right turn lane
- CR 400 N eastbound – 1 shared through/right turn lane
- CR 400 N westbound – 1 shared left/through lane

### Evans Avenue & County Road 325 E (unsignalized – stop sign)

- CR 325 N southbound – 1 shared left/right turn lane
- Evans Avenue eastbound – 1 shared left/through lane
- Evans Avenue westbound – 1 shared through/right turn lane

### Vale Park Road/County Road 400 N & County Road 325 E (unsignalized – 4-way stop)

- CR 325 N northbound – 1 shared left/through/right turn lane
  - CR 325 N southbound – 1 shared left/through/right turn lane
  - CR 400 N eastbound – 1 shared left/through/right turn lane
  - CR 400 N westbound – 1 shared left/through/right turn lane
- County Road 500 N & County Road 325 E (unsignalized - ???)

- CR 325 N northbound – 1 shared left/right turn lane
- CR 500 N eastbound – 1 shared through/right turn lane
- CR 500 N westbound – 1 shared left/through lane

Figure A.1, Water Main Concept Plan

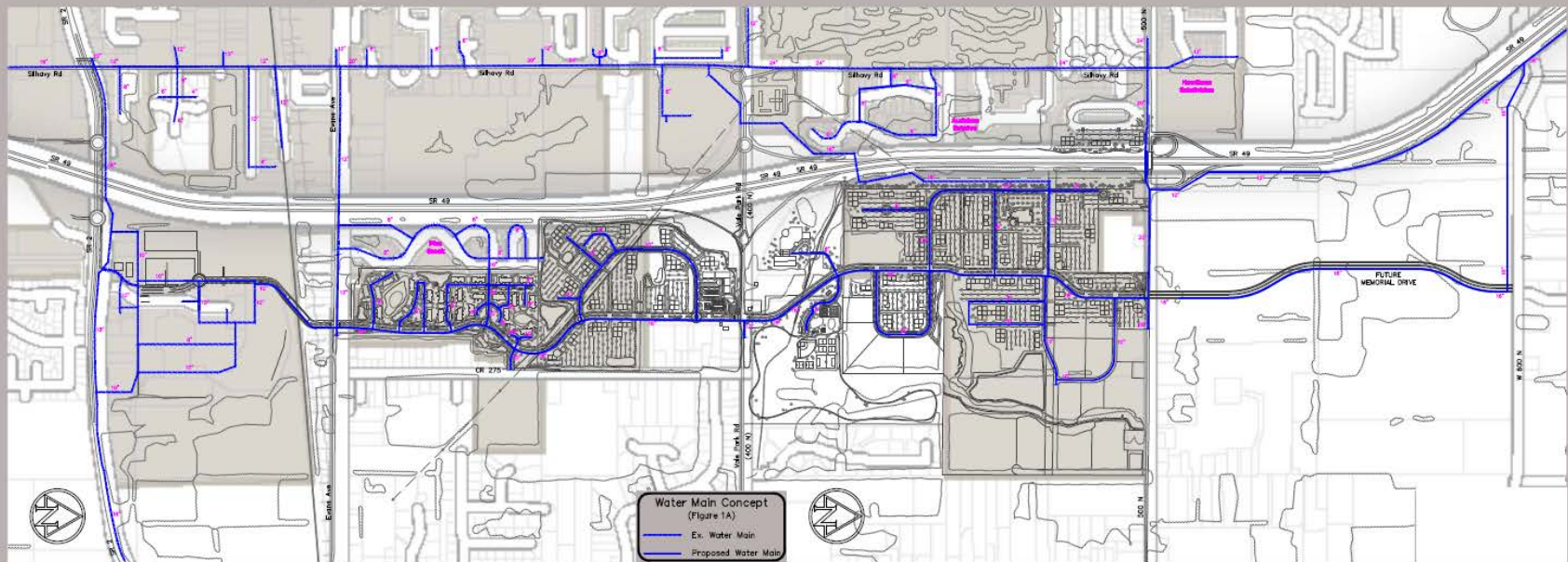



Figure A.2, Sanitary Sewer Concept Plan

